

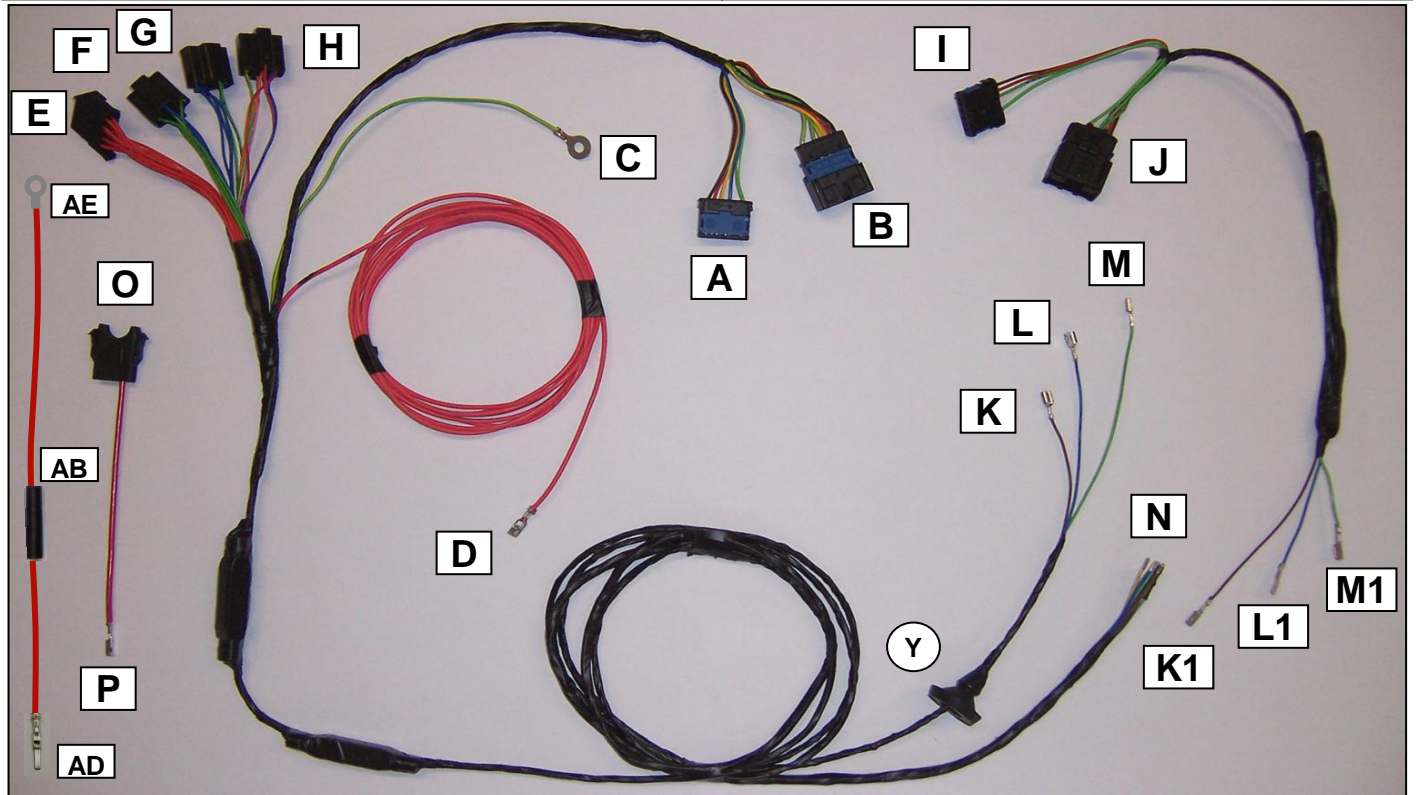

**BERLINGO II / PARTNER II**

Einbauanleitung elektrosatz Anhängervorrichtung mit 12N Steckdose  
 Fitting instructions electric wiringkit towbar with 12N socket  
 Montage-handleiding elektrokabelset voor trekhaak met 12N contactos

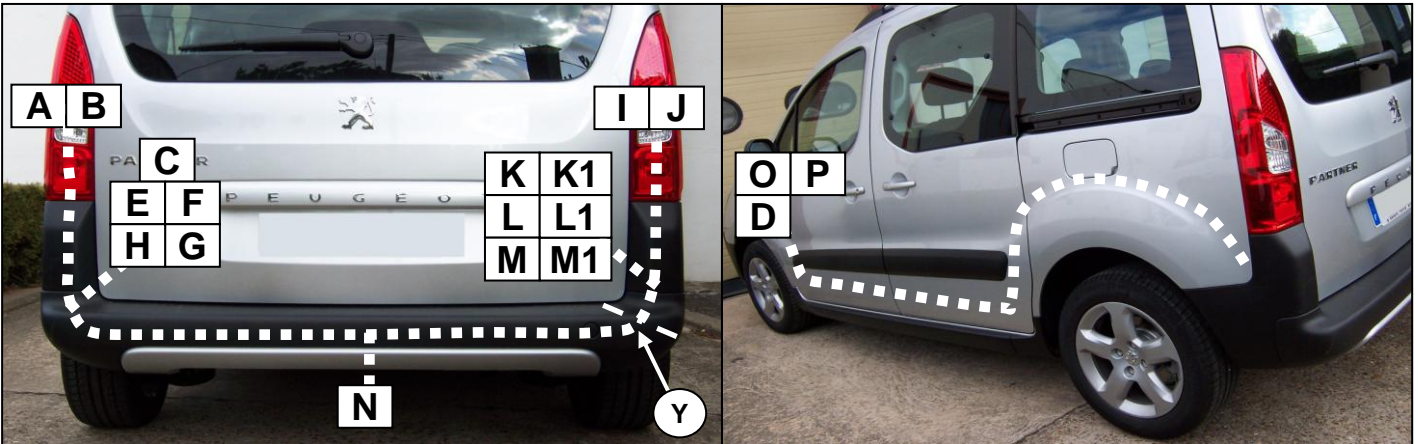

Liste des pièces / Teilliste / Part list / Onderdelenlijst :

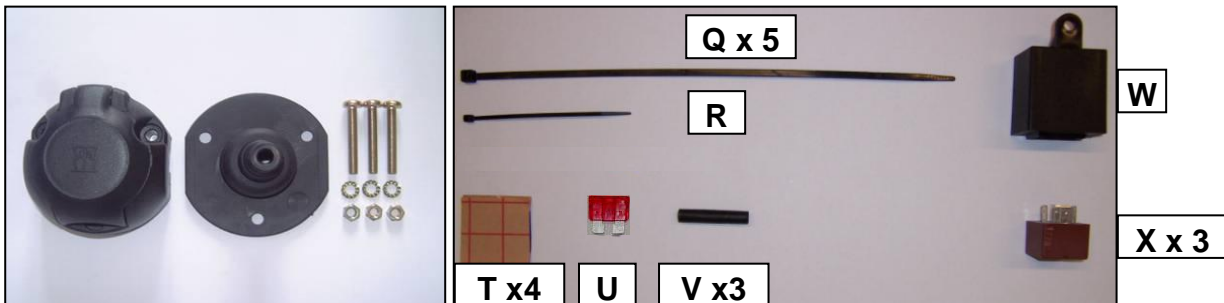

Cette notice ne peut être divulguée ou reproduite, partiellement ou en totalité, sans accord de la société.

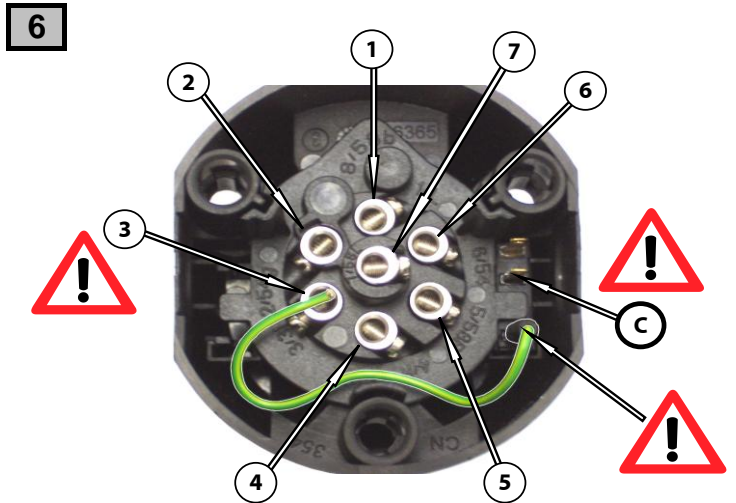
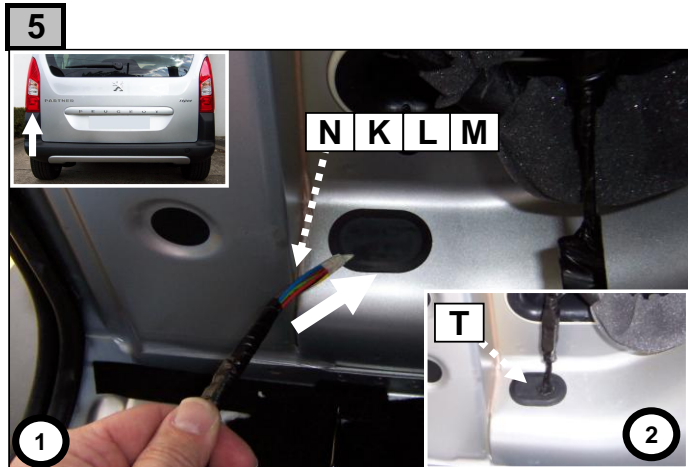
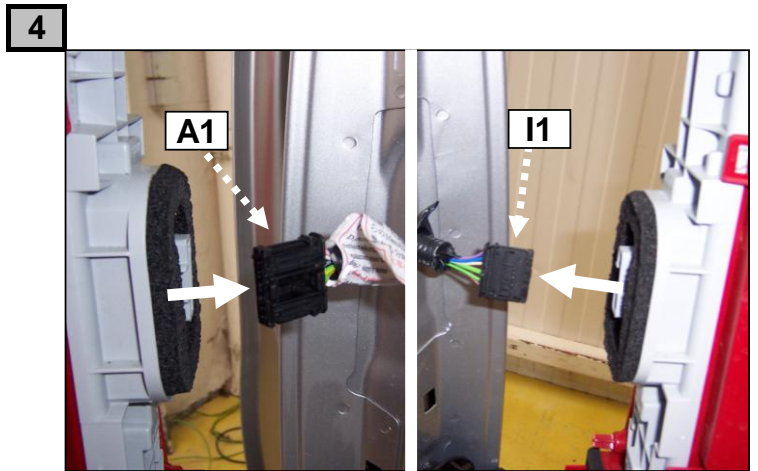
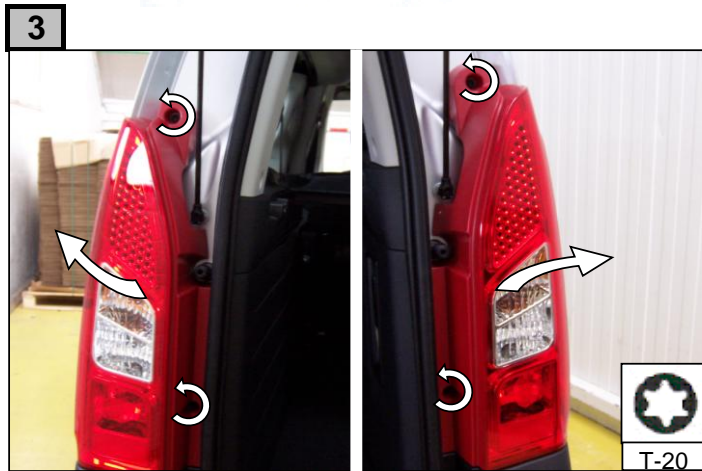
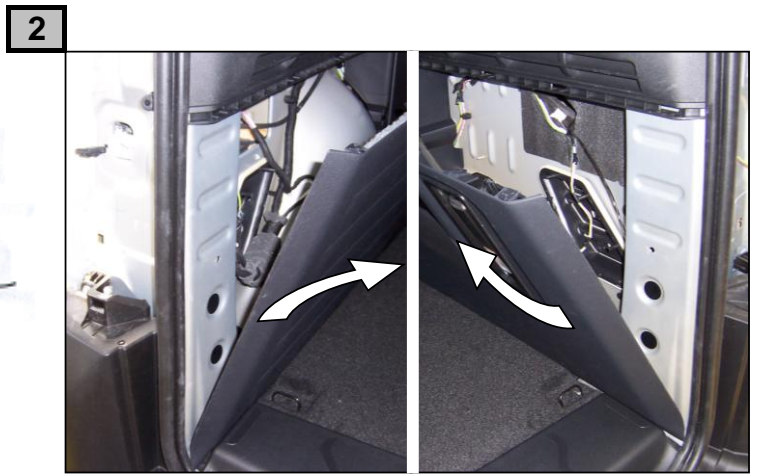
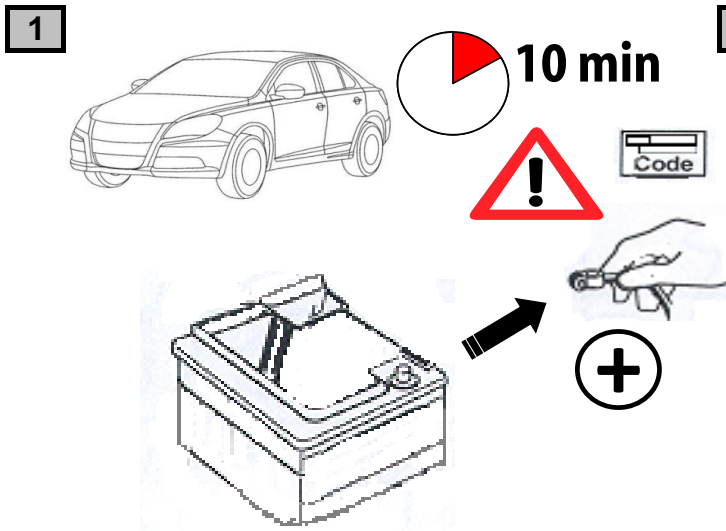

	<b>1/L</b>	<b>2/54g</b>	<b>3/31</b>	<b>4/R</b>	<b>5/58R</b>	<b>6/54</b>	<b>7/58L</b>	<b>(C)</b>
	21+5 W	21W		21+5 W	40 W	63 W	40 W	
<b>F</b>	Jaune	Bleu	Vert/jaune	Vert	Marron	Rouge	Noir	Gris
<b>D</b>	Gelb	Blau	Grün/gelb	Grün	Braun	Rot	Schwarz	Grau
<b>GB</b>	Yellow	Blue	Green/yellow	Green	Brown	Red	Black	Grey
<b>NL</b>	Geel	Blauw	Groen/geel	Groen	Bruin	Rood	Zwart	Grijs
<b>P</b>	Amarelo	Azul	Verde/amarelo	Verde	Castanho	Vermelho	Preto	Cinzeno
<b>I</b>	Giallo	Blu	Verde/giallo	Verde	Marrone	Rosso	Nero	Grigio
<b>E</b>	Amarillo	Azul	Verde/amarillo	Verde	Marron	Rojo	Negro	Gris

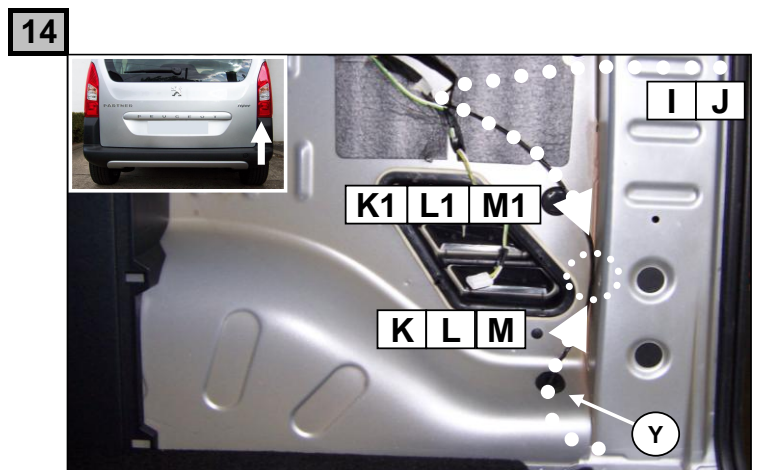
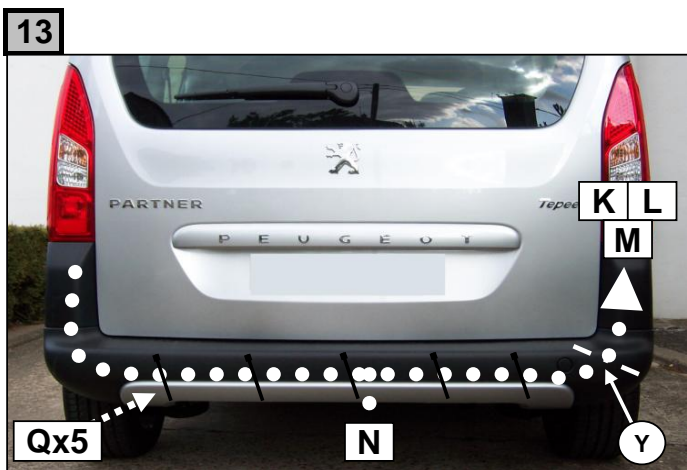
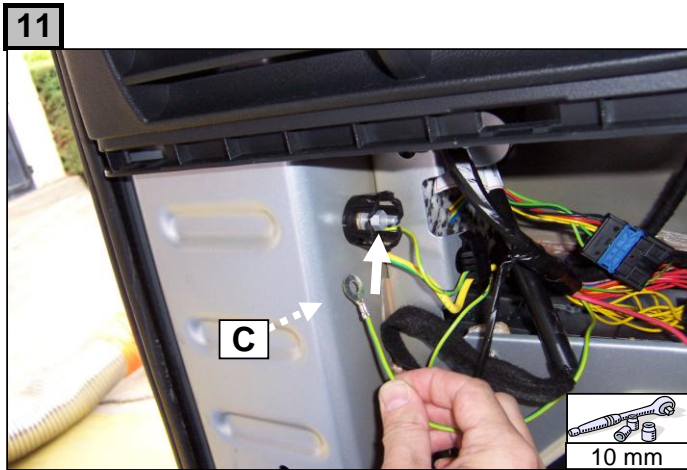
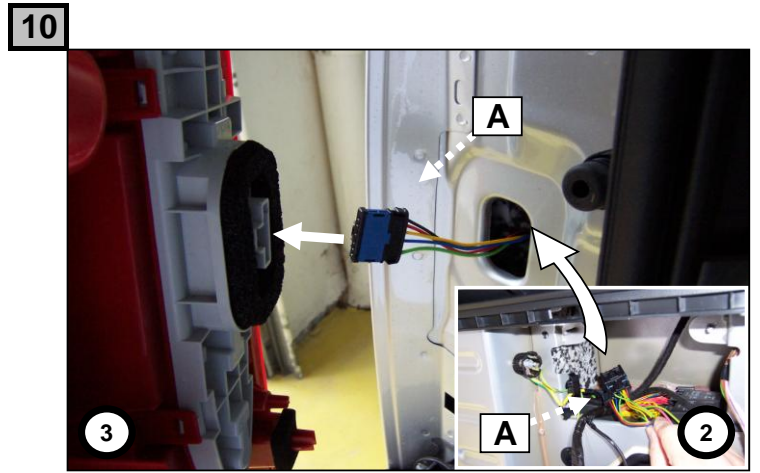
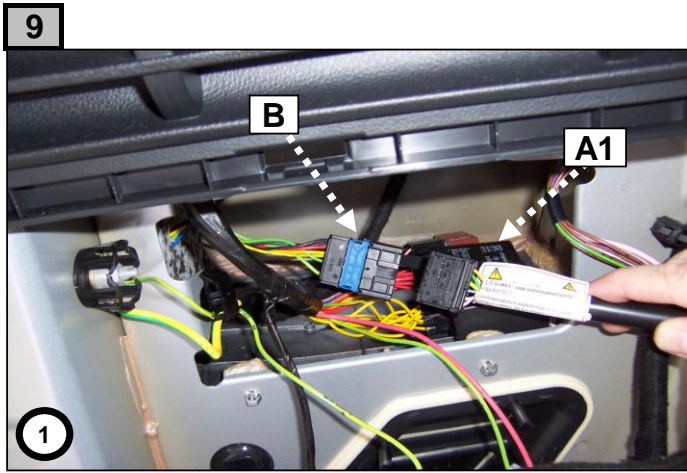
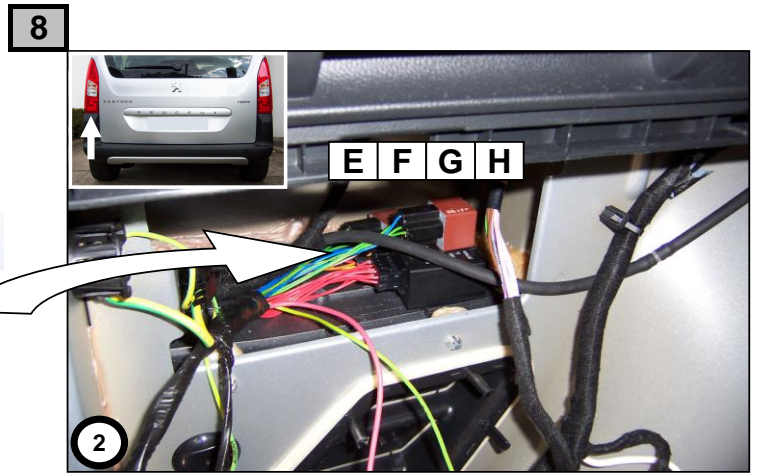
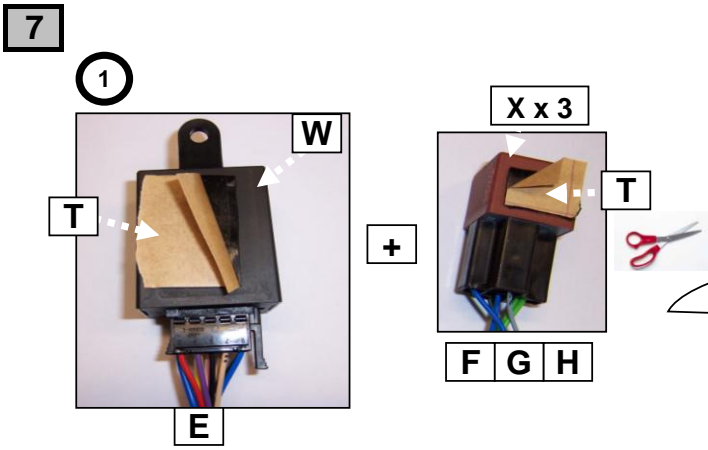

15

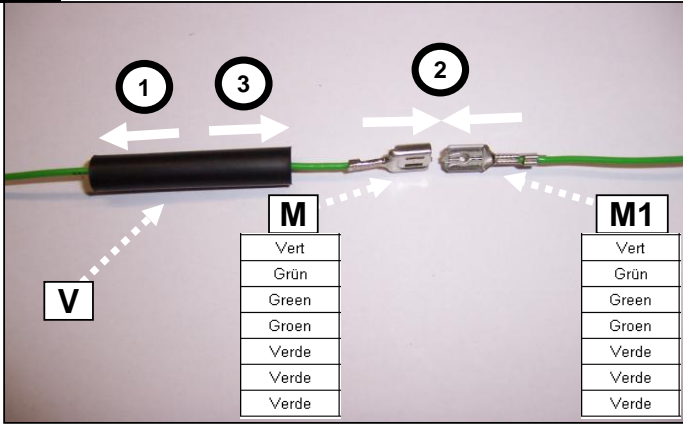

16

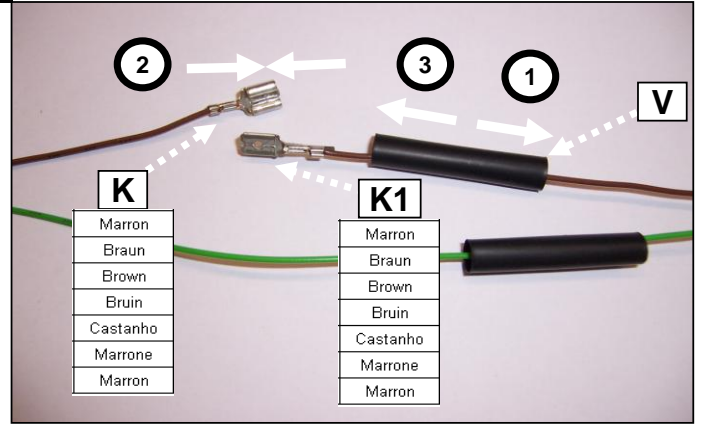

17

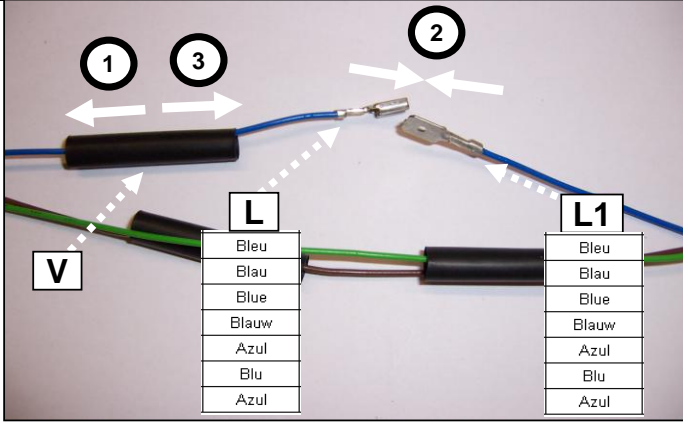

18

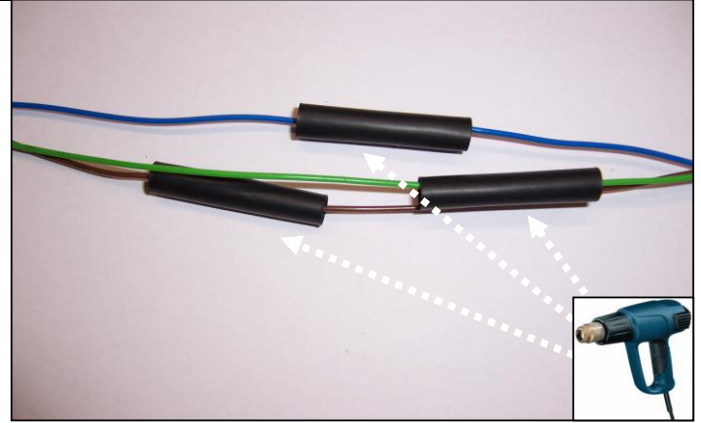

19

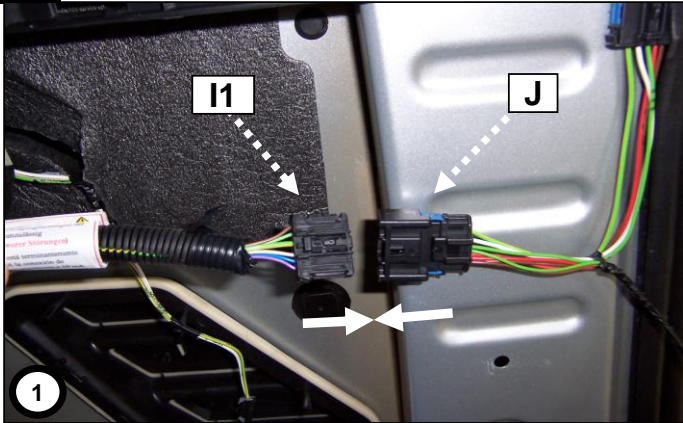

20

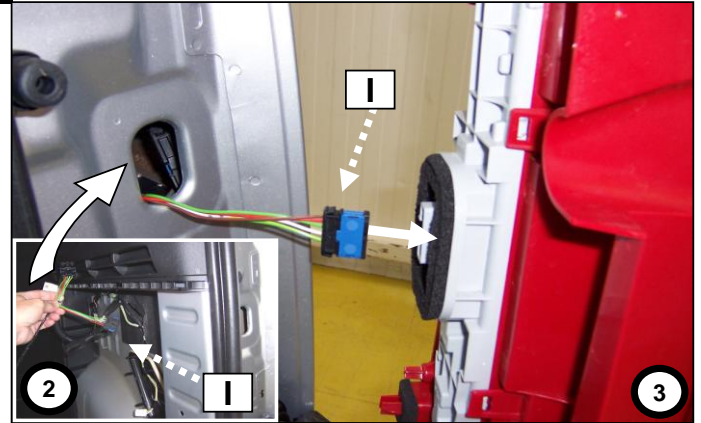

21



22

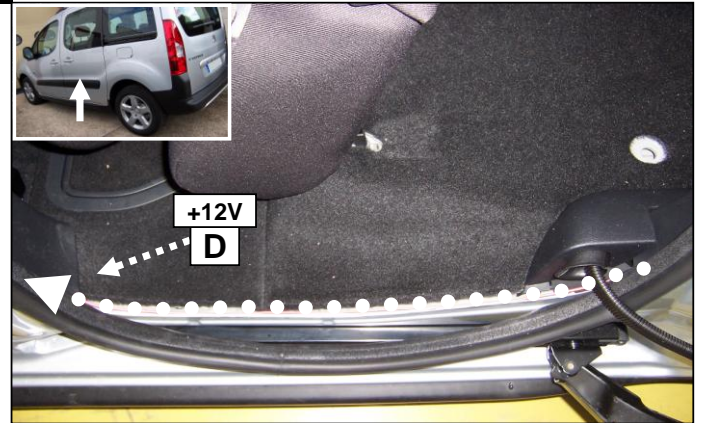

23

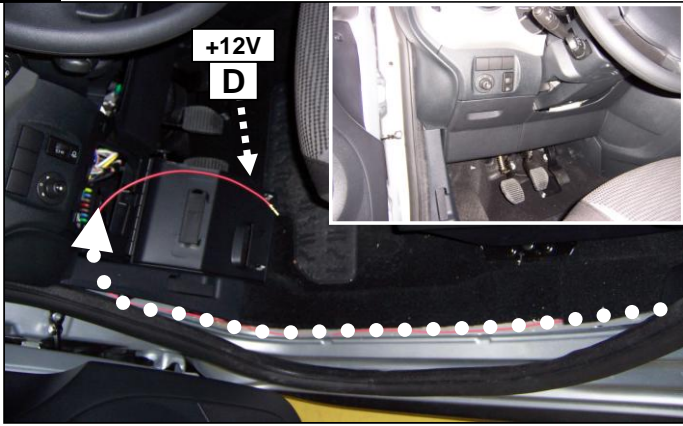

24

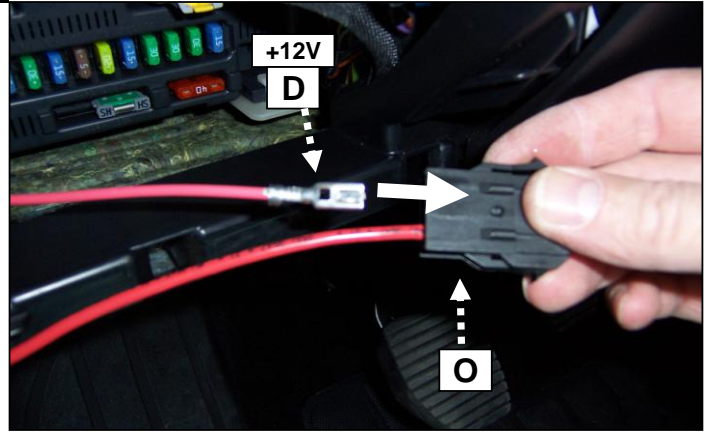

25

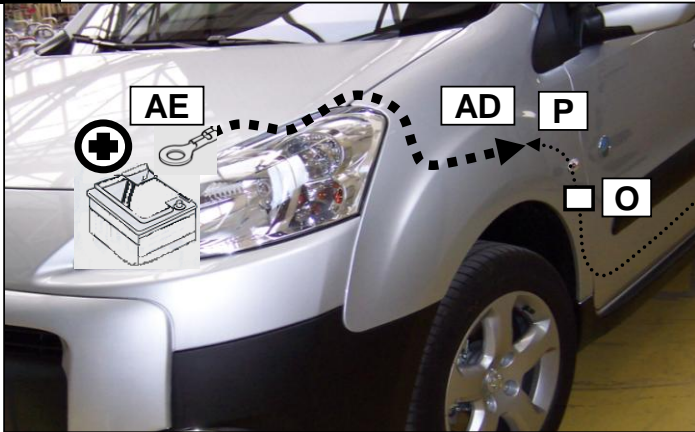

26

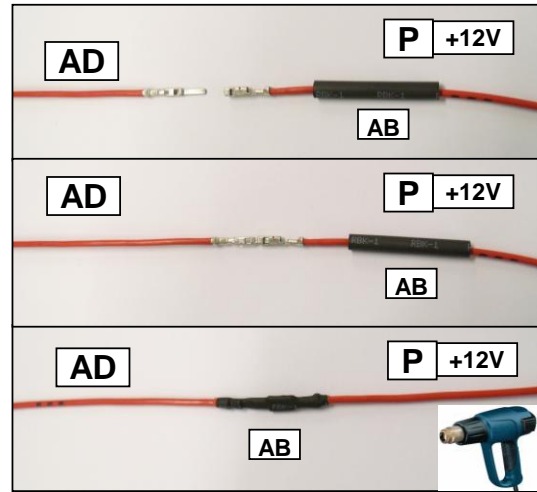

27

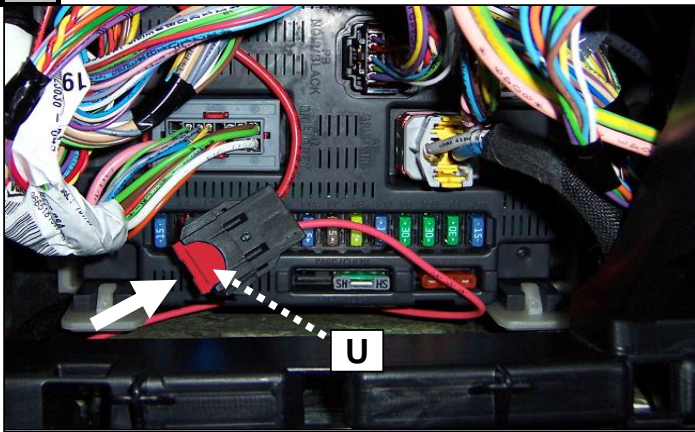

28

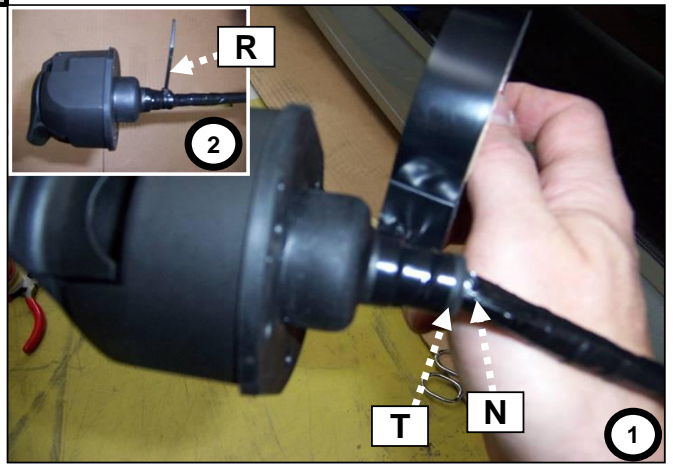

29



Code

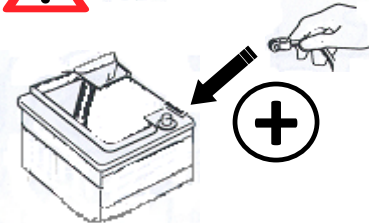

Contrôler les fonctions  
 Funktionen kontrollieren  
 Check functions  
 Controler functies

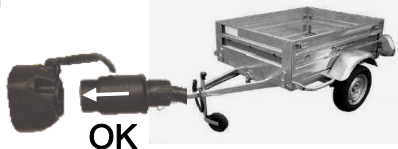

30

